

KEY PLAN

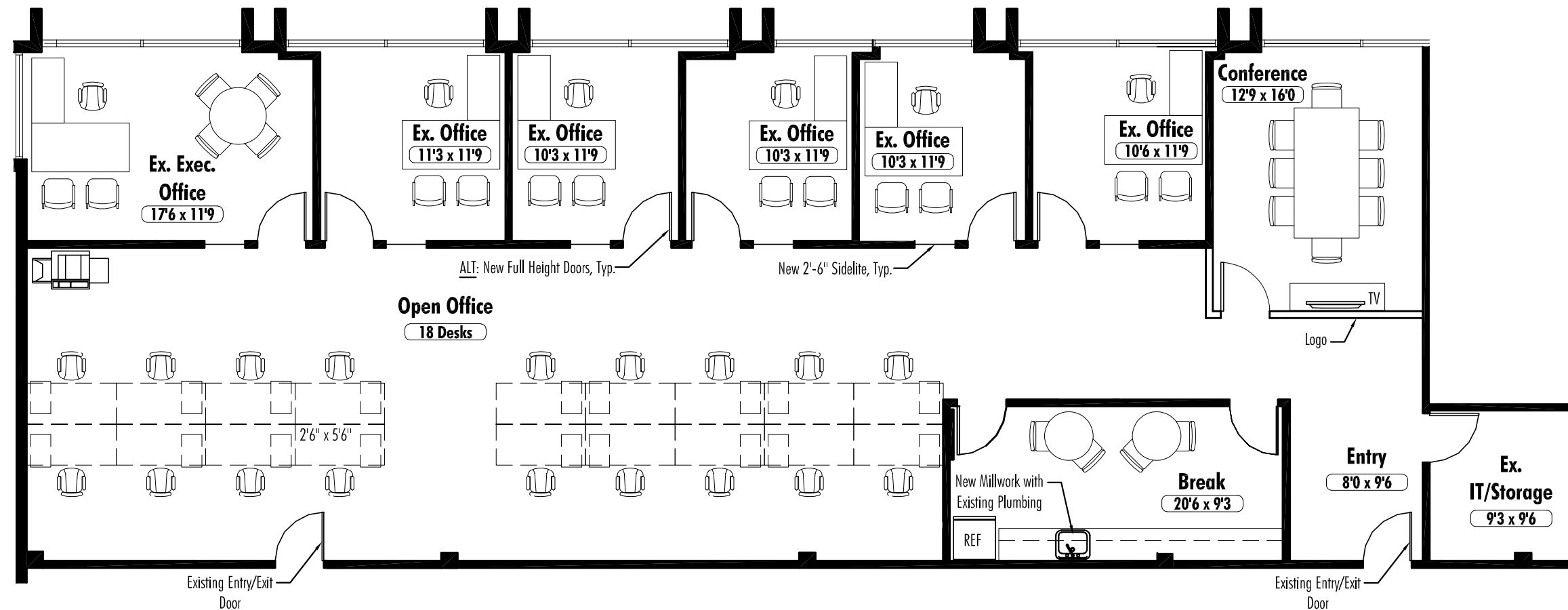

**Schematic Plan #3**

WORKSTATIONS	18
PRIVATE OFFICES	6
CONFERENCE	1
IT/STORAGE	1
BREAK	1

\*All furniture shown is for representational purposes only.

\*\*This suite has not been field surveyed by NELSON.



U:\Proj\CBRE\GA\The District The Flats 2951\19.01546.00-The District The Flats 2951\_Spec 211\DRAWINGS\ARCH\1\_SD\SC3\_The Flats 2951\_Suite211.dwg

PLAN NORTH  
SCALE: 1/8" = 1'-0"  
(WHEN PRINTED ON 11x17)

